

AGENDA

MEETING OF THE BOARD OF TRUSTEES OF SOUTHERN ILLINOIS UNIVERSITY

Thursday, February 9, 2023
Approximately 10:00 a.m.

MUC Conference Center – Rooms #2061, 2062 and 2063
Morris University Center (2nd Floor)
Southern Illinois University Edwardsville
Edwardsville, Illinois
live stream video at siusystem.edu via Youtube
and through Zoom

Call to Order by Chair

Roll Call

Annual Election of Officers, Executive Committee, and Board Representatives, and
Annual Appointments by the Chair

Approval of Minutes of the Meetings Held November 30 and December 1, 2022

BOARD OF TRUSTEES ACTIVITIES

- A. Trustee Reports
- B. Committee Reports
 - (1) Executive Committee

EXECUTIVE OFFICER REPORTS

- C. President, Southern Illinois University
- D. Chancellor, Southern Illinois University Edwardsville
- E. Chancellor, Southern Illinois University Carbondale
 - (1) Dean and Provost, Southern Illinois University School of Medicine

PUBLIC COMMENTS AND QUESTIONS

RECEIPT OF INFORMATION AND NOTICE ITEMS

- F. Report of Purchase Orders and Contracts, October, November, and December, 2022, SIUC
- G. Report of Purchase Orders and Contracts, October, November, and December, 2022, SIUE

RATIFICATION OF PERSONNEL MATTERS

- H. Changes in Faculty-Administrative Payroll - SIUC
- I. Changes in Faculty-Administrative Payroll – SIUE

ITEMS RECOMMENDED FOR APPROVAL BY THE PRESIDENT

- J. Proposed Revisions to the Board of Trustees Debt Policy [Amendments to 5 Policies of the Board P]
- K. Approval of Purchase: 340B Pharmaceutical Program, School of Medicine, SIUC
- L. Approval to Acquire Real Estate: 1904 North Illinois Avenue, Carbondale, Head Start Program, SIUC
- M. Award of Contracts: Resurface/Rebuild Various Parking Lots, and Parking Roadways and Install Updated Lighting, SIUE
- N. Approval of Easements: Temporary Construction Easements, City of Edwardsville, and Permanent Easement, Illinois Department of Transportation, Illinois Highway 157, SIUE
- O. Revised Project Budget and Award of Contracts: BioLaunch Core Facility, McLafferty Annex, Carbondale Campus, SIUC

Adjournment

Southern Illinois University
Board of Trustees
February 9, 2023

SUMMARY REPORT OF PURCHASE ORDERS AND CONTRACTS
AWARDED DURING THE MONTH OF OCTOBER 2022
SOUTHERN ILLINOIS UNIVERSITY CARBONDALE

Section	Quantity	Amount
Less than the State Required Bid Limit	193	\$3,397,280.43
State Required Bid Limit to \$999,999.99	8	\$2,124,092.49
\$1,000,000.00 and Over	0	\$0.00
Total	201	\$5,521,372.92

SOUTHERN ILLINOIS UNIVERSITY CARBONDALE
DETAILED REPORT OF PURCHASE ORDERS AND CONTRACTS OF
LESS THAN STATE REQUIRED BID LIMIT
AWARDED DURING THE MONTH OF OCTOBER 2022

<u>Transactions Under State Required Bid Limit</u>	<u>Quantity</u>	<u>Amount</u>
	193	\$3,397,280.43

SOUTHERN ILLINOIS UNIVERSITY CARBONDALE
DETAILED REPORT OF PURCHASE ORDERS AND CONTRACTS OF
STATE REQUIRED BID LIMIT TO \$999,999
AWARDED DURING THE MONTH OF OCTOBER 2022

<u>Purchase Orders and Contracts of State Required Bid Limit to \$999,999:</u> <i>State Appropriated and Income Funds for General Educational Operations</i>			
<u>No.</u>	<u>Vendor</u>	<u>Description</u>	<u>Amount</u>
145504	Elsevier Inc Maryland Heights, MO	Fall 2022 textbooks and testing materials for Nursing students.	\$106,035.93

<u>Purchase Orders and Contracts of State Required Bid Limit to \$999,999:</u> <i>Restricted Funds for General Educational Operations</i>			
<u>No.</u>	<u>Vendor</u>	<u>Description</u>	<u>Amount</u>
145694	MSF&W Consulting Inc Springfield, IL	Technical assistance for the DHS Youth Employment Training Technical Assistance and Support project through June 30, 2023.	\$110,160.00
145439	Lotek Wireless Inc Newmarket, Ontario, Canada	Wildlife Research Lab equipment for tracking wildlife.	\$211,054.56
145697	University Accounting Service LLC Farmers Branch, TX	Perkins loan servicing through June 30, 2024. Options to renew July 1, 2024-June 30, 2026 and July 1, 2026-June 30, 2028.	\$225,000.00

145690	MSF&W Consulting Inc Springfield, IL	Technical assistance, design, and data systems development support for the SNAP project through June 30, 2023.	\$253,260.00
145228	Goshen Educational Consulting Inc Edwardsville, IL	Data collection and analytics for Special Education Behavior Assessment and Training grant project through June 30, 2024.	\$275,000.00

Purchase Orders and Contracts of State Required Bid Limit to \$999,999:
Service Department Funds

<u>No.</u>	<u>Vendor</u>	<u>Description</u>	<u>Amount</u>
145449	E T Simonds Construction Co Carbondale, IL	Overlay the Motorcycle Rider Program driving range. IFB M081622	\$285,719.00
145640	Joiner Sheet Metal & Roofing Inc Highland, IL	Replacement of roof systems at Bowyer and Steagall Hall. IFB M061322R	\$657,863.00

SUMMARY REPORT OF PURCHASE ORDERS AND CONTRACTS
AWARDED DURING THE MONTH OF OCTOBER 2022
SOUTHERN ILLINOIS UNIVERSITY SCHOOL OF MEDICINE

Section	Quantity	Amount
Less than the State Required Bid Limit	55	\$1,098,063.00
State Required Bid Limit to \$999,999.99	2	\$671,158.20
\$1,000,000.00 and Over	0	\$0.00
Total	57	\$1,769,221.20

SOUTHERN ILLINOIS UNIVERSITY SCHOOL OF MEDICINE
DETAILED REPORT OF PURCHASE ORDERS AND CONTRACTS OF
LESS THAN STATE REQUIRED BID LIMIT
AWARDED DURING THE MONTH OF OCTOBER 2022

<u>Transactions Under State Required Bid Limit</u>	<u>Quantity</u>	<u>Amount</u>
	55	\$1,098,063.00

SOUTHERN ILLINOIS UNIVERSITY SCHOOL OF MEDICINE
DETAILED REPORT OF PURCHASE ORDERS AND CONTRACTS OF
STATE REQUIRED BID LIMIT TO \$999,999.99
AWARDED DURING THE MONTH OF OCTOBER 2022

<u>Purchase Orders and Contracts of State Required Bid Limit to \$999,999.99:</u> <i>Non-appropriated Funds General Educational Operations</i>			
<u>No.</u>	<u>Vendor</u>	<u>Description</u>	<u>Amount</u>
145389	Charles River Laboratories Incorporated Wilmington, MA	Animals purchased for laboratory research for the period of July 1, 2022 through June 30, 2023.	\$500,000.00
145488	Decatur Memorial Hospital Decatur, IL	Rental of 6,638 gsf of space located at 302 W Hay Street, Decatur, for SIU Healthcare, for the period of July 1, 2022 through June 30, 2023.	\$171,158.20

SUMMARY REPORT OF PURCHASE ORDERS AND CONTRACTS
AWARDED DURING THE MONTH OF NOVEMBER 2022
SOUTHERN ILLINOIS UNIVERSITY CARBONDALE

Section	Quantity	Amount
Less than the State Required Bid Limit	44	\$1,138,209.40
State Required Bid Limit to \$999,999.99	9	\$1,713,401.50
\$1,000,000.00 and Over	0	\$0.00
Total	53	\$2,851,610.90

SOUTHERN ILLINOIS UNIVERSITY CARBONDALE
DETAILED REPORT OF PURCHASE ORDERS AND CONTRACTS OF
LESS THAN STATE REQUIRED BID LIMIT
AWARDED DURING THE MONTH OF NOVEMBER 2022

<u>Transactions Under State Required Bid Limit</u>	<u>Quantity</u>	<u>Amount</u>
	44	\$1,138,209.40

SOUTHERN ILLINOIS UNIVERSITY CARBONDALE
DETAILED REPORT OF PURCHASE ORDERS AND CONTRACTS OF
STATE REQUIRED BID LIMIT TO \$999,999
AWARDED DURING THE MONTH OF NOVEMBER 2022

<u>Purchase Orders and Contracts of State Required Bid Limit to \$999,999:</u> <i>State Appropriated and Income Funds for General Educational Operations</i>			
<u>No.</u>	<u>Vendor</u>	<u>Description</u>	<u>Amount</u>
145809	WCIU Limited Partnership DBA WCIU HCIU Chicago, IL	Television commercials through June 30, 2023.	\$199,050.00

<u>Purchase Orders and Contracts of State Required Bid Limit to \$999,999:</u> <i>Restricted Funds for General Educational Operations</i>			
<u>No.</u>	<u>Vendor</u>	<u>Description</u>	<u>Amount</u>
145769	National Science Teachers Association Arlington, VA	Services for development of assessment clusters for Illinois Science Assessment through June 30, 2023.	\$100,000.00
145796	Innovasea Marine Systems Canada Inc Nova Scotia, Canada	Coded acoustic receiver.	\$118,167.00

<u>Purchase Orders and Contracts of State Required Bid Limit to \$999,999:</u> <i>Service Department Funds</i>			
<u>No.</u>	<u>Vendor</u>	<u>Description</u>	<u>Amount</u>
145819	Carrier Corporation Maryland Heights, MO	Cooling tower for the Power Plant.	\$194,117.00

<u>Purchase Orders and Contracts of State Required Bid Limit to \$999,999:</u> <i>Auxiliary Funds</i>			
<u>No.</u>	<u>Vendor</u>	<u>Description</u>	<u>Amount</u>
145710	Pepsi MidAmerica Company Marion, IL	Pepsi products for Lentz and Trueblood dining halls through October 15, 2024.	\$125,000.00

<u>Purchase Orders and Contracts of State Required Bid Limit to \$999,999:</u> <i>Non-Appropriated Funds</i>			
<u>No.</u>	<u>Vendor</u>	<u>Description</u>	<u>Amount</u>
144760	LTN Global Communications Incorporated DBA Niles Media Liberty, MO	On-site broadcast services through June 30, 2024.	\$361,296.00

<u>Purchase Orders and Contracts of State Required Bid Limit to \$999,999:</u> <i>Multi-Account Distributions</i>			
<u>No.</u>	<u>Vendor</u>	<u>Description</u>	<u>Amount</u>
145492	Basis Global Technologies Inc Chicago, IL	Digital advertising services through August 31, 2023. <i>State Appropriated and Income Funds for General Educational Operations</i> \$170,000.00 <i>Non-Appropriated Funds for General Educational Operations</i> \$175,000.00	\$345,000.00

Purchase Orders and Contracts of State Required Bid Limit to \$999,999: <i>Multi-Account Distributions</i>			
<u>No.</u>	<u>Vendor</u>	<u>Description</u>	<u>Amount</u>
145744	CDW Government LLC Vernon Hills, IL	Cohesity DataProtect add-on subscription license three-year agreement. <i>Service Department Funds</i> \$108,406.03 <i>Non-Appropriated Funds for General Educational Operations</i> \$54,203.01	\$162,609.04
145814	Thomas Scientific Holdings LLC DBA NCI Inc Minneapolis, MN	3D imaging equipment. <i>State Appropriated Funds for General Educational Operations</i> \$662.61 <i>Restricted Funds for General Educational Operations</i> \$99,947.00 <i>Non-Appropriated Funds for General Educational Operations</i> \$7,552.85	\$108,162.46

SUMMARY REPORT OF PURCHASE ORDERS AND CONTRACTS
AWARDED DURING THE MONTH OF NOVEMBER 2022
SOUTHERN ILLINOIS UNIVERSITY SCHOOL OF MEDICINE

Section	Quantity	Amount
Less than the State Required Bid Limit	33	\$689,179.25
State Required Bid Limit to \$999,999.99	5	\$1,848,948.38
\$1,000,000.00 and Over	0	\$0.00
Total	38	\$2,538,127.63

SOUTHERN ILLINOIS UNIVERSITY SCHOOL OF MEDICINE
DETAILED REPORT OF PURCHASE ORDERS AND CONTRACTS OF
LESS THAN STATE REQUIRED BID LIMIT
AWARDED DURING THE MONTH OF NOVEMBER 2022

<u>Transactions Under State Required Bid Limit</u>	<u>Quantity</u>	<u>Amount</u>
	33	\$689,179.25

SOUTHERN ILLINOIS UNIVERSITY SCHOOL OF MEDICINE
DETAILED REPORT OF PURCHASE ORDERS AND CONTRACTS OF
STATE REQUIRED BID LIMIT TO \$999,999.99
AWARDED DURING THE MONTH OF NOVEMBER 2022

<u>Purchase Orders and Contracts of State Required Bid Limit to \$999,999.99:</u> <i>Non-appropriated Funds General Educational Operations</i>			
<u>No.</u>	<u>Vendor</u>	<u>Description</u>	<u>Amount</u>
145711	ADC Partners LTD Springfield, IL	Rental of 12,248 gsf of space located at 319 E. Madison St., Springfield, for Psychiatry, for the period of November 1, 2022 through June 30, 2023.	\$100,025.36
145714	St John's Hospital Springfield, IL	Rental of 17,078 gsf of space located at 301 N. 8 th St., Springfield, for SIU Healthcare, for the period of November 1, 2022 through June 30, 2023.	\$243,532.26
145742	Morgan County Jacksonville, IL	License agreement for rental of space and support staff at 425 E. State St., Jacksonville, for Family Community Medicine, for the period of November 1, 2022 through June 30, 2023.	\$201,020.80
145747	Decatur Memorial Hospital Decatur, IL	Rental of 33,310 gsf of space located at 102 W. Kenwood, Decatur, for Family and Community Medicine, for the period of November 1, 2022 through June 30, 2023.	\$882,554.96

145729	Core Construction Services of Illinois Peoria, IL	Auditorium renovations at 801 N. Rutledge, Springfield.	\$421,815.00
--------	---	--	--------------

SUMMARY REPORT OF PURCHASE ORDERS AND CONTRACTS
AWARDED DURING THE MONTH OF DECEMBER 2022
SOUTHERN ILLINOIS UNIVERSITY CARBONDALE

Section	Quantity	Amount
Less than the State Required Bid Limit	33	\$1,242,617.03
State Required Bid Limit to \$999,999.99	2	\$541,378.24
\$1,000,000.00 and Over	0	\$0.00
Total	35	\$1,783,995.27

SOUTHERN ILLINOIS UNIVERSITY CARBONDALE
DETAILED REPORT OF PURCHASE ORDERS AND CONTRACTS OF
LESS THAN STATE REQUIRED BID LIMIT
AWARDED DURING THE MONTH OF DECEMBER 2022

<u>Transactions Under State Required Bid Limit</u>	<u>Quantity</u>	<u>Amount</u>
	33	\$1,242,617.03

SOUTHERN ILLINOIS UNIVERSITY CARBONDALE
DETAILED REPORT OF PURCHASE ORDERS AND CONTRACTS OF
STATE REQUIRED BID LIMIT TO \$999,999
AWARDED DURING THE MONTH OF DECEMBER 2022

<u>Purchase Orders and Contracts of State Required Bid Limit to \$999,999:</u> <i>Non-Appropriated Funds for General Educational Operations</i>			
<u>No.</u>	<u>Vendor</u>	<u>Description</u>	<u>Amount</u>
145947	New England Flight Watch LLC DBA CharterSearch Pacific, MO	Charter jet air travel.	\$154,140.00

<u>Purchase Orders and Contracts of State Required Bid Limit to \$999,999:</u> <i>Multi-Account Distributions</i>			
<u>No.</u>	<u>Vendor</u>	<u>Description</u>	<u>Amount</u>
145927	City of Carbondale Carbondale, IL	Fire protection services through June 30, 2023. <i>State Appropriated and Income Funds for General Educational Operations</i> \$108,700.00 <i>Service Department Funds</i> \$278,538.24	\$387,238.24

SUMMARY REPORT OF PURCHASE ORDERS AND CONTRACTS
AWARDED DURING THE MONTH OF DECEMBER 2022
SOUTHERN ILLINOIS UNIVERSITY SCHOOL OF MEDICINE

Section	Quantity	Amount
Less than the State Required Bid Limit	29	\$538,286.70
State Required Bid Limit to \$999,999.99	3	\$861,391.80
\$1,000,000.00 and Over	0	\$0.00
Total	32	\$1,399,678.50

SOUTHERN ILLINOIS UNIVERSITY SCHOOL OF MEDICINE
DETAILED REPORT OF PURCHASE ORDERS AND CONTRACTS OF
LESS THAN STATE REQUIRED BID LIMIT
AWARDED DURING THE MONTH OF DECEMBER 2022

<u>Transactions Under State Required Bid Limit</u>	<u>Quantity</u>	<u>Amount</u>
	29	\$538,286.70

SOUTHERN ILLINOIS UNIVERSITY SCHOOL OF MEDICINE
DETAILED REPORT OF PURCHASE ORDERS AND CONTRACTS OF
STATE REQUIRED BID LIMIT TO \$999,999.99
AWARDED DURING THE MONTH OF DECEMBER 2022

<u>Purchase Orders and Contracts of State Required Bid Limit to \$999,999.99:</u> <i>Non-appropriated Funds General Educational Operations</i>			
<u>No.</u>	<u>Vendor</u>	<u>Description</u>	<u>Amount</u>
145893	Morgan County Jacksonville, IL	Rental of 6,000 gsf of space located at 425 E. State St., Jacksonville, for Family and Community Medicine, for the period of January 1, 2023 through June 30, 2023.	\$135,000.00
145921	Blessing Hospital Quincy, IL	Rental of 25,393 gsf of space located at 612 N. 11 th St., Quincy, for Family and Community Medicine, for the period of January 1, 2023 through June 30, 2023.	\$284,820.80
145786	Memorial Medical Center Springfield, IL	Rental of 39,057 gsf of space located at 701 N. 1 st St., Springfield, for SIU Healthcare, for the period of November 1, 2022 through June 30, 2023.	\$441,571.00

Southern Illinois University
Board of Trustees
February 9, 2023

SUMMARY REPORT OF PURCHASE ORDERS AND CONTRACTS
AWARDED DURING THE MONTH OF OCTOBER 2022
SOUTHERN ILLINOIS UNIVERSITY EDWARDSVILLE

Section	Quantity	Amount
Less than the State Required Bid Limit	2,730	\$2,682,778.68
State Required Bid Limit to \$999,999.99	2	\$318,656.64
\$1,000,000.00 and Over	0	\$0.00
Total	2,732	\$3,001,435.32

SOUTHERN ILLINOIS UNIVERSITY EDWARDSVILLE
DETAILED REPORT OF PURCHASE ORDERS AND CONTRACTS OF
LESS THAN STATE REQUIRED BID LIMIT
AWARDED DURING THE MONTH OF OCTOBER 2022

<u>Transactions Under State Required Bid Limit</u>	<u>Quantity</u>	<u>Amount</u>
	2,730	\$2,682,778.68

SOUTHERN ILLINOIS UNIVERSITY EDWARDSVILLE
DETAILED REPORT OF PURCHASE ORDERS AND CONTRACTS OF
STATE REQUIRED BID LIMIT TO \$999,999
AWARDED DURING THE MONTH OF OCTOBER 2022

<u>Purchase Orders and Contracts of State Required Bid Limit to \$999,999:</u> <i>Non-Appropriated Funds for General Educational Operations</i>			
<u>No.</u>	<u>Vendor</u>	<u>Description</u>	<u>Amount</u>
145626	Ohio Valley Conference Brentwood, Tennessee	Provision of payment for Ohio Valley Conference Arbiter pay for SIUE Men's and Women's Basketball officials during the 2022-2023 competition season.	\$100,056.60

<u>Purchase Orders and Contracts of State Required Bid Limit to \$999,999:</u> <i>Multi-Account Distribution</i>			
<u>No.</u>	<u>Vendor</u>	<u>Description</u>	<u>Amount</u>
145455	Jackie Joyner-Kersee Foundation East Saint Louis, Illinois	Provision of payment for rent associated with the leasing of Jackie Joyner-Kersee Center Head Start Center.	\$218,600.04

SUMMARY REPORT OF PURCHASE ORDERS AND CONTRACTS
AWARDED DURING THE MONTH OF NOVEMBER 2022
SOUTHERN ILLINOIS UNIVERSITY EDWARDSVILLE

Section	Quantity	Amount
Less than the State Required Bid Limit	2,769	\$2,393,507.55
State Required Bid Limit to \$999,999.99	6	\$1,170,506.00
\$1,000,000.00 and Over	0	\$0.00
Total	2,775	\$3,564,013.55

SOUTHERN ILLINOIS UNIVERSITY EDWARDSVILLE
DETAILED REPORT OF PURCHASE ORDERS AND CONTRACTS OF
LESS THAN STATE REQUIRED BID LIMIT
AWARDED DURING THE MONTH OF NOVEMBER 2022

<u>Transactions Under State Required Bid Limit</u>	<u>Quantity</u>	<u>Amount</u>
	2,769	\$2,393,507.55

SOUTHERN ILLINOIS UNIVERSITY EDWARDSVILLE
DETAILED REPORT OF PURCHASE ORDERS AND CONTRACTS OF
STATE REQUIRED BID LIMIT TO \$999,999
AWARDED DURING THE MONTH OF NOVEMBER 2022

<u>Purchase Orders and Contracts of State Required Bid Limit to \$999,999:</u> <i>State Appropriated Funds</i>			
<u>No.</u>	<u>Vendor</u>	<u>Description</u>	<u>Amount</u>
145795	Career Mosaic PVT Limited Navrangpura Ahmedabad, Gujarat India	Provision of payment for the recruitment of international degree and non-degree seeking students for the period of July 1, 2022 through June 30, 2023.	\$198,000.00
145836	SIU Edwardsville Foundation Edwardsville, Illinois	Provision for payment to the SIUE Foundation for Fundraising and Alumni Membership Services in accordance with the terms and conditions of the Master Contract.	\$190,000.00

<u>Purchase Orders and Contracts of State Required Bid Limit to \$999,999:</u> <i>Service Cash</i>			
<u>No.</u>	<u>Vendor</u>	<u>Description</u>	<u>Amount</u>
145811	JEN Mechanical Incorporated Godfrey, Illinois	Furnish all labor, materials and equipment to replace existing chiller in Prairie Hall.	\$210,000.00

145818	Behrmann Company Saint Louis, Missouri	Provide 3 Lochinvar 850-MBH Boilers and 2 Lochinvar FBN150-M9 Boilers.	\$185,506.00
--------	---	--	--------------

<u>Purchase Orders and Contracts of State Required Bid Limit to \$999,999:</u> <i>Auxiliary Funds</i>			
<u>No.</u>	<u>Vendor</u>	<u>Description</u>	<u>Amount</u>
145756	Top Job Cleaning Service LLC Manchester, Missouri	Provision for full and partial clean service for Bluff Hall, Prairie Hall, Woodland Hall and Evergreen Hall for the period January 1, 2023 through December 31, 2023.	\$181,000.00
145758	Top Job Cleaning Service LLC Manchester, Missouri	Provision for full and partial cleaning service for Cougar Village Apartments for the time period of January 1, 2023 through December 31, 2023.	\$206,000.00

SUMMARY REPORT OF PURCHASE ORDERS AND CONTRACTS
AWARDED DURING THE MONTH OF DECEMBER 2022
SOUTHERN ILLINOIS UNIVERSITY EDWARDSVILLE

Section	Quantity	Amount
Less than the State Required Bid Limit	1,856	\$1,842,482.05
State Required Bid Limit to \$999,999.99	2	\$219,437.76
\$1,000,000.00 and Over	0	\$0.00
Total	1,858	\$2,061,919.81

SOUTHERN ILLINOIS UNIVERSITY EDWARDSVILLE
DETAILED REPORT OF PURCHASE ORDERS AND CONTRACTS OF
LESS THAN STATE REQUIRED BID LIMIT
AWARDED DURING THE MONTH OF DECEMBER 2022

<u>Transactions Under State Required Bid Limit</u>	<u>Quantity</u>	<u>Amount</u>
	1,856	\$1,842,482.05

SOUTHERN ILLINOIS UNIVERSITY EDWARDSVILLE
DETAILED REPORT OF PURCHASE ORDERS AND CONTRACTS OF
STATE REQUIRED BID LIMIT TO \$999,999
AWARDED DURING THE MONTH OF DECEMBER 2022

<u>Purchase Orders and Contracts of State Required Bid Limit to \$999,999:</u> <i>Restricted Funds for General Educational Purposes</i>			
<u>No.</u>	<u>Vendor</u>	<u>Description</u>	<u>Amount</u>
145892	Laerdal Medical Corporation Wappingers Falls, New York	Nursing Anne Simulator, SimMan ALS, and SimBaby and additional accessories.	\$115,964.60

<u>Purchase Orders and Contracts of State Required Bid Limit to \$999,999:</u> <i>Multi-Account Distribution</i>			
<u>No.</u>	<u>Vendor</u>	<u>Description</u>	<u>Amount</u>
145954	New Life Interdenominational Church Lebanon, Illinois	Provision of payment for rent associated with the leasing of New Life in Christ Interdenominational Church classroom space, playground space, and other access detailed in lease for SIUE Head Start.	\$103,473.16

Southern Illinois University
Board of Trustees
February 9, 2023

CHANGES IN FACULTY-ADMINISTRATIVE PAYROLL – SIUC

The following changes in faculty-administrative payroll are submitted to the Board of Trustees for ratification in accordance with the Board Policy on Personnel Approval (2 Policies of the Board B). Additional detailed information is available from the Office of the Chancellor. Where appropriate, salary is reported on a monthly basis and on either an academic year (AY) or fiscal year (FY) basis.

- A. Initial Appointments of Faculty to Tenured and Tenure Track and Initial Appointments and Promotions of Professional Staff (If the person previously had a University appointment, it is so noted. Otherwise, the person is a new University employee.)

	<u>Name</u>	<u>Rank/Title</u>	<u>Department</u>	<u>Effective Date</u>	<u>Salary</u>
1.	Alsobeh, Anas Mohammad Ramadan	Assistant Professor	School of Computing	01/01/2023	\$ 9,250.00/MO \$ 83,250.00/AY
2.	Chappanda Nanaiah, Karumbaiah	Assistant Professor	School of Applied Engineering and Technology	01/01/2023	\$ 8,890.00/MO \$ 80,010.00/AY
3.	Clark, Willie Augustus	Chief Information Officer (prev. Interim Chief Information Officer)	Information Technology	11/04/2022	\$ 15,000.00/MO \$ 180,000.00/FY (Previous Salary - \$ 11,901.00/MO \$ 142,812.00/FY)
4.	Epplin, Kent A	Director (prev. Associate Director)	Student Center	01/01/2023	\$ 7,500.00/MO \$ 90,000.00/FY (Previous Salary - \$ 6,131.00/MO \$ 73,572.00/FY)
5.	Grant, Zachary Steele	Assistant Coach	Intercollegiate Athletics	12/06/2022	\$ 5,000.00/MO \$ 60,000.00/FY
6.	Hudgins, Molly Jayne	Snr. Associate AD for Compliance, Student Services, & NIL	Intercollegiate Athletics	11/07/2022	\$ 10,833.34/MO \$130,000.08/FY

7.	Jiter, Sarah Kristine	Associate Director, Operations (prev. Coord. Of Recruit & Retention)	Undergraduate Admissions	11/21/2022	\$ 5,000.00/MO \$ 60,000.00/FY (Previous Salary - \$ 4,080.00/MO \$ 48,960.00/FY)
8.	Kidwai, Juhi	Assistant Professor	School of Health Sciences	01/01/2023	\$ 8,000.00/MO \$ 72,000.00/AY
9.	Lind, Douglas William	Assoc. Dean 75% w/Law Library Director 25% (prev. Law Library Director)	School of Law	01/06/2023	\$ 13,509.00/MO \$ 162,117.00/FY (Previous Salary - \$ 12,567.00/MO \$ 150,804.00/FY)
10.	Perry, Cathy J	Sr Assoc Athletic Director for Finance-Saluki Athletics CFO	Intercollegiate Athletics	01/01/2023	\$ 7,916.67/MO \$ 95,000.04/FY
11.	Roohallah, Khatami	Assistant Professor	School of Electrical, Computer, & Biomedical Engineering	01/23/2023	\$ 9,874.00/MO \$ 88,866.00/AY
12.	Smith, Jennifer Lynn	Interim Associate Dean 75%, Professor 25% (prev. Professor)	College of Liberal Arts, School of Languages & Linguistics	12/01/2022	\$ 9,126.00/MO \$ 82,134.00/FY (Previous Salary - \$ 8,296.00/MO \$ 18,666.00/AY)
13.	Toth, Elizabeth	Assistant Coach	Intercollegiate Athletics	01/16/2023	\$ 3,833.33/MO \$ 45,999.96/FY
14.	Wilkins, Kenneth	Assistant Professor	School of Aviation	01/01/2023	\$ 7,350.00/MO \$ 66,150.00/AY
15.	Wilson, Destiney Lynn	Nursing Skills Lab Assistant	School of Health Sciences	01/01/2023	\$ 4,407.00/MO \$ 52,884.00/FY

B. Grant of Leave With Pay: None to report

C. Grant of Academic Tenure: None to report.

D. Promotions of Tenured and Tenure Track Faculty: None to report.

CHANGES IN FACULTY-ADMINISTRATIVE PAYROLL – SIU SCHOOL OF MEDICINE

The following changes in faculty-administrative payroll at the School of Medicine/Springfield campus are submitted to the Board of Trustees for ratification in accordance with the Board Policy on Personnel Approval (2 Policies of the Board B). Additional detailed information is on file in the Office of the Dean and Provost.. Where appropriate, salary is reported on a monthly basis and on either an academic year (AY) or fiscal year (FY) basis.

E. Initial Appointments of Faculty to Tenured and Tenure Track and Initial Appointments and Promotions of Professional Staff (If the person previously had a University appointment, it is so noted. Otherwise, the person is a new University employee.)

	<u>Name</u>	<u>Rank/Title</u>	<u>Department</u>	<u>Effective Date</u>	<u>Salary</u>
1.	Beavers, James	Researcher I	Pharmacology	01/09/23	\$2,936.25/MO \$35,235.00/FY
2.	Bland, Lori	Certified Nurse Practitioner	Family & Community Medicine	01/09/23	\$8,312.50/MO \$99,750.00/FY
3.	Boaz, Lauren	Audiologist	Otolaryngology	12/12/22	\$5,895.92/MO \$70,751.04/FY
4.	Bolinski, Rebecca	Research Project Coordinator	Population Science & Policy	11/14/22	\$4,333.33/MO \$52,000.00/FY
5.	Bunner, Lauren	Certified Nurse Practitioner	Pediatrics	12/12/22	\$9,166.67/MO \$110,000.00/FY
6.	Carey, Jodie	Executive Director, Clinical Finance	Healthcare Admin	11/01/22	\$15,416.67/MO \$185,000.00/FY (Previously \$11,956.80/MO \$143,481.60)

7.	Daniels, Lisa	Department Administrator	Cancer Institute	11/14/22	\$10,416.67MO \$125,000.00 FY (Previously \$6,651.24MO \$79,814.88 FY)
8.	Foster, Anne	Certified Nurse Practitioner	Surgery	11/23/22	\$7,916.67/MO \$95,000.00/FY
9.	Franklin, Jeffrey	Executive Director of CRHSSD (Previously Director of CRHSSD)	Center of Rural Health	9/16/22	\$11,919.09/MO, \$143,029.10/FY (Previously \$10,250.00/MO, \$123,000.00/YR)
10.	Ham, Erin	Research Project Specialist	Population Science & Policy	11/14/22	\$3,750.00/MO \$45,000.00/FY
11.	Kelly, Colleen	Certified Physician Assistant	Psychiatry	01/09/23	\$9,583.33/MO \$115,000.00/FY
12.	Lindgren, Sherri	Certified Nurse Practitioner	Family & Community Medicine	12/12/22	\$11,250.00/MO \$135,000.00/FY
13.	Madonia, Christine	Assistant to the Chair of OB/GYN	OB/GYN	12/05/22	\$9,992.58/MO \$119,910.96 (Previously \$6,499.66/MO \$77,995.92FY)
14.	McMahon, Vicki	Curriculum Development Specialist	Education & Curriculum	11/14/22	\$7,369.42/MO \$88,433.04/FY
15.	Montgomery, Benjamin	Assistant Professor of Clinical Internal Medicine	Correctional Medicine	01/09/23	\$20,834.00/MO \$250,000.00/FY

16.	Stoller, Megan	Pharmacists	Simmons Cancer Institute	12/12/22	\$10,106.99/MO \$121,283.88/FY
17.	Velten, Lauren	Research Project Specialist	Population Science & Policy	01/09/23	\$3,500.00/MO \$42,000.00/FY
18.	Zwick, Jill	Certified Nurse Practitioner	Family and Community Medicine	11/01/22	\$9,760.42/MO \$117,125.04/FY (Previously \$8,510.42/MO \$102,125.04/FY)

F. Grant of Leave With Pay: None to report

G. Grant of Academic Tenure:

	<u>Name</u>	<u>Title on Effective Date of Tenure</u>	<u>Department</u>	<u>Effective Date</u>
1.	Crosby, Dana	Professor	Otolaryngology & Head and Neck Surgery	7/1/2023
2.	Robinson, William	Professor	Surgery	7/1/2023
3.	Stewart, David	Professor	Surgery	7/1/2023
4.	Young, Matthew	Associate Professor	Biomedical Science	7/1/2023

H. Promotions of Tenured and Tenure Track Faculty:

	<u>Name</u>	<u>Title on Effective Date of Tenure</u>	<u>Department</u>	<u>Effective Date</u>
1.	Ahamed, Mohamed Farooq	Associate Clinical Professor	Pediatrics	7/1/2023
2.	Al Sawaf, Abdul	Associate Clinical Professor	Neurology	7/1/2023
3.	Allam, Hesham	Clinical Professor	Neurology	7/1/2023
4.	Cianciolo, Anna	Professor	Medical Education	7/1/2023
5.	Darling, Ginger	Clinical Professor	Pediatrics	7/1/2023
6.	Delfino, Kristin	Research Associate Professor	Surgery	7/1/2023
7.	Diemer, Donald	Clinical Professor	Family & Community Medicine	7/1/2023
8.	Dynda, Danuta	Research Associate Professor	Surgery	7/1/2023
9.	El-Amin, Wendi Willis	Clinical Professor	Family & Community Medicine	7/1/2023
10.	Gagnon, Keith	Associate Professor	Biomedical Science	7/1/2023
11.	Miller-Spears, Erica	Associate Clinical Professor	Family & Community Medicine	7/1/2023
12.	Patterson, Janet	Clinical Professor	Pediatrics	7/1/2023

13.	Pointer, Carolyn	Associate Professor	Medical Humanities	7/1/2023
14.	Quader, Zafar	Associate Clinical Professor	Internal Medicine	7/1/2023
15.	Robinson, Robert	Clinical Professor	Internal Medicine	7/1/2023
16.	Rose, Jennifer	Associate Clinical Professor	Family & Community Medicine	7/1/2023
17.	Salam, Hossam Abdul	Associate Clinical Professor	Pediatrics	7/1/2023
18.	Saleh, Ezzeldin	Associate Clinical Professor	Pediatrics	7/1/2023
19.	Sattovia, Stacy	Clinical Professor	Internal Medicine	7/1/2023
20.	Scott, Mary Katherine	Associate Clinical Professor	Pediatrics	7/1/2023

Southern Illinois University
Board of Trustees
February 9, 2023

CHANGES IN FACULTY-ADMINISTRATIVE PAYROLL – SIUE

The following changes in faculty-administrative payroll are submitted to the Board of Trustees for ratification in accordance with the Board Policy on Personnel Approval (2 Policies of the Board B). Additional detailed information is on file in the Office of the Chancellor. Where appropriate, salary is reported on a monthly basis and on either an academic year (AY) or fiscal year (FY) basis.

A. Initial Appointments of Faculty to Tenured and Tenure Track and Initial Appointments and Promotions of Professional Staff (If the person previously had a University appointment, it is so noted. Otherwise, the person is a new University employee.)

	<u>Name</u>	<u>Rank/Title</u>	<u>Department</u>	<u>Effective Date</u>	<u>Salary</u>
1.	Drukteinis, Saulius	Dean (previously: Associate Dean)	School of Dental Medicine	01/16/2023	\$12,500.00/mo \$300,000.00/FY (previously: \$7,852.19/mo \$188,452.56/FY)
2.	Izquierdo, Mark	Associate Director	Intercollegiate Athletics	11/29/2022	\$6,6166.68/mo \$74,000.16/FY
3.	Nauroth, Markus	Assistant Professor	CMIS	01/01/2023	\$14,000.00/mo \$126,000.00/AY
4.	Robinder, Wendy	Academic Advisor II	School of Engineering	11/02/2022	\$3,791.66/mo \$45,499.92/FY
5.	Schoenherr, Mark	Academic Advisor II	School of Nursing	11/07/2022	\$3,955.52/mo \$47,466.24/FY

B. Leaves of Absence With Pay –

	<u>Name</u>	<u>Type of Leave</u>	<u>Department</u>	<u>% of Leave</u>	<u>Date</u>
1.	Belasen, Ariel	Sabbatical	Economics & Finance	100%	8/16/2023-12/31/2023
	<u>Purpose:</u> Professor Belasen will examine COVID-19 impact on hospital financial performance and assess underrepresented students' participation in undergraduate research programs on subsequent academic and career outcomes.				
2.	Conoyer, Sarah	Sabbatical	Psychology	100%	8/16/2023-12/31/2023
	<u>Purpose:</u> Professor Conoyer will research increasing graduate students' skills and self-efficacy in academic screening, intervention, and data-based decision making by expanding intervention services in the SIUE Attention and Behavior Clinic.				
3.	Dimick, Brigham	Sabbatical	Art & Design	100%	1/01/2024-5/15/2024
	<u>Purpose:</u> Professor Dimick will employ imagery of prison architecture and spaces of containment in new paintings that explore incarceration by the state and as a state of mind.				
4.	Florido Berrocal, Joaquin	Sabbatical	Foreign Languages & Literature	100%	1/01/2024-5/15/2024
	<u>Purpose:</u> Professor Florido Berrocal will research and write an academic article about the power of contemporary Spanish film to change and become part of the collective memory of historical needs.				
5.	Gamage, Thoshitha	Sabbatical	Computer Science	50%	8/16/2023-8/15/2024
	<u>Purpose:</u> Professor Gamage will research power grid integrity management using distributed control.				

- | | | | | | |
|----|-------------|------------|------------------------|------|---------------------|
| 6. | Hicks, Gary | Sabbatical | Mass
Communications | 100% | 1/01/2024-5/15/2024 |
|----|-------------|------------|------------------------|------|---------------------|

Purpose: Professor Hicks will compare media framing and the stigma of monkeypox in 2022 with HIV/AIDS in the 1980's using textual analysis. He will then submit a paper to AEJMC conference.

- | | | | | | |
|----|-------------------|------------|---------|------|----------------------|
| 7. | Hinz, Christienne | Sabbatical | History | 100% | 8/16/2023-12/31/2023 |
|----|-------------------|------------|---------|------|----------------------|

Purpose: Professor Hinz will develop a proposal for her history game "Bosses and the Bossed" to submit to Central Michigan University.

- | | | | | | |
|----|------------------|------------|-----------------------------|------|---------------------|
| 8. | Leem, Koungh Hee | Sabbatical | Mathematics
& Statistics | 100% | 1/01/2024-5/15/2024 |
|----|------------------|------------|-----------------------------|------|---------------------|

Purpose: Professor Leem will work on her project to improve the reconstruction of an object using MLSM (Modified Linear Sampling Method), which will result in submitting peer-reviewed research papers for publications.

- | | | | | | |
|----|----------------|------------|----------------------|------|---------------------|
| 9. | Lewis, Timothy | Sabbatical | Political
Science | 100% | 1/01/2024-5/15/2024 |
|----|----------------|------------|----------------------|------|---------------------|

Purpose: Professor Lewis will produce four chapters of a book manuscript detailing blackness beyond biology to dismantle the white defense to racism: "I have black friends."

- | | | | | | |
|-----|----------|------------|-----------------------------|------|----------------------|
| 10. | Liu, Jun | Sabbatical | Mathematics
& Statistics | 100% | 8/16/2023-12/31/2023 |
|-----|----------|------------|-----------------------------|------|----------------------|

Purpose: Professor Liu will produce at least one manuscript studying parallel-in-time algorithms and their applications in data science for submission to peer-reviewed journals.

- | | | | | | |
|-----|-----------------|------------|---------------------|------|---------------------|
| 11. | Oberweis, Trish | Sabbatical | Criminal
Justice | 100% | 1/01/2024-5/15/2024 |
|-----|-----------------|------------|---------------------|------|---------------------|

Purpose: Professor Oberweis will produce a manuscript for peer-reviewed publication that analyzes collected data on the prevalence of campus sexual assault and student attitudes about gender roles/norms.

- | | | | | | |
|-----|------------------|------------|---------------------------|------|---------------------|
| 12. | VanSlette, Sarah | Sabbatical | Applied
Communications | 100% | 1/01/2024-5/15/2024 |
|-----|------------------|------------|---------------------------|------|---------------------|

Purpose: Professor VanSlette will write and submit one article for publication and presentation at a national or international conference on the subject of diversity, equity, and inclusion in PR pedagogy.

- | | | | | | |
|-----|---------------|------------|---------------------------|------|----------------------|
| 13. | Wang, Fengxia | Sabbatical | Mechanical
Engineering | 100% | 8/16/2023-12/31/2023 |
|-----|---------------|------------|---------------------------|------|----------------------|

Purpose: Professor Wang will do research on robot dynamics and control which will result in a published journal paper.

- | | | | | | |
|-----|--------------|------------|--------------------------|------|----------------------|
| 14. | Ware, Robert | Sabbatical | School of
Engineering | 100% | 8/16/2023-12/31/2023 |
|-----|--------------|------------|--------------------------|------|----------------------|

Purpose: Professor Ware will go to Oxford University to confer with colleagues and complete work on a book. He will submit the book for publication.

- | | | | | | |
|-----|--------------|------------|---------------------------|------|---------------------|
| 15. | Zeng, Yuping | Sabbatical | Management
& Marketing | 100% | 1/01/2024-5/15/2024 |
|-----|--------------|------------|---------------------------|------|---------------------|

Purpose: Professor Zeng will develop a dataset and complete the first multi-country examination of the antecedents of the decertification of Certified B Corporations.

- | | | | | | |
|-----|-----------|------------|--------------------|------|---------------------|
| 16. | Zhou, Bin | Sabbatical | Geography &
GIS | 100% | 1/01/2024-5/15/2024 |
|-----|-----------|------------|--------------------|------|---------------------|

Purpose: Professor Zhou will complete four sample chapters of a book on advanced spatial modeling techniques.

C. Awards of Tenure-
None to report

D. Awards of Promotion-
None to report

Southern Illinois University
Board of Trustees
February 9, 2023

PROPOSED REVISIONS TO THE BOARD OF TRUSTEES DEBT POLICY
[AMENDMENTS TO 5 POLICIES OF THE BOARD P]

Summary

This matter seeks approval by the SIU Board of Trustees to amend 5 Policies of the Board P - Debt Policy. The Debt Policy serves as a guide for the Board Treasurer with respect to debt decisions.

Rationale for Adoption

The University first adopted a Debt Policy in February 2010. The Board later approved updates to the Debt Policy in September 2017 and, at that time, incorporated the Debt Policy into Board Policy. The Debt Policy serves as the Board's directive to the Board Treasurer with respect to the University's debt strategy. It provides guidance to govern debt issuance, provides a framework for debt procedures and internal controls, and addresses debt portfolio management strategy.

This matter will amend the Debt Policy to incorporate changes to the Securities and Exchange Commission laws, Internal Revenue Service rules and regulations, covenant requirements, update debt ratios to align with rating agency calculations, clarify governance roles and responsibilities related to the debt issuance function and to provide other clarification as needed.

The Debt Policy is also being updated to establish the annual minimum funding requirement for the Housing and Auxiliary Facilities System Repair and Replacement Reserve (HAFS RRR) account as required by the Amended and Restated Bond Resolution adopted July 1, 2021. Once this matter is approved, the minimum HAFS RRR annual funding requirement will be an amount equal to 10% of the maximum annual debt service. In addition, the Board authorizes the Board Treasurer to reduce the minimum funding level as may be deemed necessary.

Considerations Against Adoption

University officers are aware of none.

Resolution

BE IT RESOLVED, By the Board of Trustees of Southern Illinois University in regular meeting assembled, That:

(1) 5 Policies of the Board P is hereby amended as per the attached.

(2) The President of Southern Illinois University be and is hereby authorized to take whatever action may be required in the execution of this resolution.

Southern Illinois University System

Debt Policy

I. Policy Statement

The University's use of debt plays a critical role in ensuring adequate and cost-effective funding for the acquisition, construction and renovation of capital assets. Since debt is a limited resource, it must be managed strategically in order to best support the University's priorities. The following Debt Policy sets forth the guiding principles for the issuance of debt and provides a framework by which decisions will be made regarding the use and management of debt.

The University's debt management goals are to:

- Use debt as **a** means to fund mission-critical projects.
- Strategically manage debt in order to maintain continued access to capital markets and maintain an acceptable credit rating.
- ~~Limit~~ **Manage** risk within the University's debt portfolio.
- Achieve lowest cost of capital possible consistent with the first three goals.

The objectives of this policy are to:

- Outline the legal and regulatory authority by which the University can issue debt.
- Establish a framework for prioritizing projects and approving debt issuance.
- Establish guidance for debt capacity parameters.
- ~~Document~~ **Outline** debt compliance and reporting requirements.
- Provide a framework for the University's debt management strategies.

II. Legal & Regulatory Authority

All debt issued by the Southern Illinois University System will be issued under the provisions of the legal and regulatory authority described below.

1. Constitutional Authority

Article IX, Section 9 of the Constitution of the State of Illinois permits State colleges and universities to issue bonds or other evidence of indebtedness for such purposes and in such amounts as may be authorized by law, but such debt may not be secured by the full faith and credit or tax revenue of the State and cannot be repaid, directly or indirectly, from tax revenue.

2. Revenue Bonds

The Board is authorized to issue revenue bonds pursuant to the Southern Illinois University Revenue Bond Act (110 ILCS 525/1 et seq.) (the "Revenue Bond Act") for

the purpose of acquiring “projects” as defined in Section 525/2(5) and to refund bonds as provided in Section 525/4 (B) and (C). The sources of payment of such revenue bonds, as provided by the Revenue Bond Act and as authorized by resolution of the Board of Trustees, are net revenues of the project or any group of projects. The Revenue Bond Act authorizes the pledge of tuition and fees as additional security for revenue bonds.

In general, revenue bonds may be utilized for the purpose of acquiring, constructing, and equipping revenue-generating projects or for refunding previously issued revenue bonds.

3. Certificates of Participation

Between June 2009 and December 2014, the University issued certificates of participation pursuant to the authority granted in the State University Certificates of Participation Act (110 ILCS 73) (the “COPS Act”). Following the expiration of the COPS Act on December 31, 2014, authority to issue certificates of participation defaulted to authority granted by the Southern Illinois University Management Act (110 ILCS 520/0.01 et seq.) (the “Management Act”). Under the provisions of the Management Act, the Board may enter into installment contracts providing for the acquisition of various improvements by the Board paid for from the proceeds of certificates of participation representing interests in the payments to be made over time by the Board as consideration for such improvements. The certificates of participation are issued by a trustee under an indenture, which provides security for the certificates of participation.

In general, certificates of participation are used for acquiring, constructing, and equipping non-revenue producing projects, such as infrastructure, administrative or academic projects.

4. Public University Energy Conservation Financing

The Public University Energy Conservation Act (110 ILCS 62/1 et seq.) (the “Energy Conservation Act”) authorizes the Board to enter into a “guaranteed energy savings contract” with a “qualified provider” to provide “energy conservation measures” (as such terms are defined in the Energy Conservation Act). The Energy Conservation Act contains the methods for obtaining and evaluating proposals and awarding the contract. Under the guaranteed contract, the provider guarantees the University that the savings under the contract will meet or exceed the costs of the conservation measures within twenty years of the date of final installation of the measures.

Section 110 ILCS 62/25 provides that the University may issue debt certificates to finance an installment payment contract or lease purchase agreement for the purchase and installation of the energy conservation measures.

5. *Illinois Procurement Code*

The Illinois Procurement Code (30 ILCS 500) contains limitation provisions which apply both to the issuance of revenue bonds and to the issuance of installment contract certificates of participation. Service providers instrumental in the issuance of debt must be approved through a competitive request for proposal (RFP) process. Certain participants may be exempt from the procurement process. In addition, certificates of participation installment contracts are limited to a maximum duration of 10 years per the Illinois Procurement Code.

6. *Illinois Board of Higher Education*

The Board of Higher Education Act (110 ILCS 205/0.01 et seq.) requires that the University submit its plan for capital improvement of non-instructional facilities to the Illinois Board of Higher Education (the “IBHE”) for approval before final commitments are made if the total cost of the project, as approved by the Board, is in excess of \$2 million. Non-instructional facilities include, but are not limited to, residence halls, stadiums, student centers, recreational facilities, and parking lots. The IBHE shall determine whether or not any project submitted for approval is consistent with the master plan for higher education and with instructional buildings that are provided for therein.

7. *Legislative Audit Commission Guidelines*

The Legislative Audit Guidelines ~~limit~~ describe the purpose for which revenue bonds may be issued, the uses of funds, the sources of payment and the accumulation of excess reserves.

III. *Establish Framework for Prioritizing Projects and Approving Debt Issuance*

The University seeks to optimize its debt capacity by prioritizing projects and financing those projects that are critical to the mission and advance the strategic objectives of the University. Listed below are the processes established for prioritizing projects and approving the use of debt:

1. *Identify & Prioritize Projects*

Debt financed projects will be identified as early as possible. All potential debt financed projects under consideration for the next several years are discussed as to their budget, timeline, and priority. Projects should be prioritized based on their relationship to the University’s mission and strategic objectives.

2. *Internal Approval Process*

Project details are reviewed by key administrative staff to assure there is demand for the project, a reliable source of revenue is identified for debt repayment and that the financial analysis assumptions are reasonable. Projects are reviewed and approved by the Chancellor and brought forward to the President on a campus-by-

campus and programmatic basis. The President recommends project financing and brings forward to the Board of Trustees for project financing approval.

3. **Authorization to Issue Debt**

Bonds and Certificates of Participation are authorized by resolution of the Board of Trustees prior to issuance. The Board has delegated to the Board Treasurer the responsibility for overseeing the issuance of revenue bonds and other forms of external financing.

IV. Establish Guidance for Debt Capacity Parameters

Debt capacity is generally measured through ratio analysis. Ratios provide a consistent measure of the debt level carried by an institution in relation to its balance sheet, revenues and expenses. Ratio analysis provides insight into the debt capacity from two perspectives: by monitoring trends over time and in comparison to benchmarks. It is the intent of the university to maintain a strong financial position that will support a favorable ratio analysis measured against national standards, peer and in-state comparisons, and credit rating agency medians.

Below are four key quantitative ratios used by the University to evaluate its level of debt affordability and debt capacity.

- **Spendable Cash & Investments to Total Debt**– Measures the ability of the University to repay bondholders from wealth that can be accessed over time or for a specific purpose.
- **Total Debt to Earnings Before Interest, Depreciation and Amortization (EBIDA) Total Debt to Cash Flow**– Measures the ability of the University to repay its debt from the profitability of its current operations, ~~as opposed to financial reserves, and is a measure of debt affordability.~~
- **EBIDA Margin Operating Cash Flow Margin**– ~~Compares~~ **Measures** net income, before non-cash expenses, relative to operating revenue to indicate the amount of cash the University generates to support its strategic and capital investments.
- **Maximum Annual Debt Service (MADS) Coverage Debt Service Coverage**– Measures the margin of protection for the maximum annual debt service payments from annual operations.

The University recognizes that its strategy and mission must be the primary drivers of its capital investment and use of debt. External credit ratings provide a view on debt capacity and affordability, and will be used to help maintain a strong financial profile.

V. Debt Compliance and Reporting Requirements

In order to have continued access to the capital financing markets, the University must comply with Securities and Exchange Commission (SEC) laws, various Internal Revenue Service rules and regulations, and ~~bond~~ covenant requirements. Compliance and reporting

are required both upon the issuance of debt and during the post-issuance phase which extends through and beyond the life of the debt obligation. The Board Treasurer is responsible for ensuring these compliance and reporting requirements are maintained.

1. Compliance with the SEC Laws

The University will meet its ongoing disclosure requirements in accordance with the Securities Exchange Commission Rule 15c2-12, by submitting financial reports, statistical data, and any other material events as required.

2. Compliance with IRS Regulations

In order to access tax-exempt financing, the University must comply with all applicable IRS regulations including, but not limited to, regulations relating to the use of bond proceeds, the use of bond financed facilities, and arbitrage in order to maintain the debt instrument's tax-exempt status.

3. Compliance with Covenants

Debt issuance often comes with covenants, which are legally enforceable commitments made by the issuer. These covenants include the Interest Sinking Fund, Debt Service Reserve and Repair & Replacement Reserve funding requirements and distribution of financial reports. In fulfilling such covenants, the Board hereby establishes that the minimum annual deposit to the HAFS Repair & Replacement Reserve will be an amount equal to 10% of the Maximum Annual Debt Service or such other lesser amount as may be determined by the Board Treasurer.

4. Debt Compliance Policy

The Board Treasurer has established a Debt Compliance Policy, which includes, but is not limited to, the following procedures and processes used to assist in monitoring these compliance and reporting requirements.

- Responsibility for Maintaining Compliance
- Private Business Use
- Arbitrage Rebate
- Investment of Debt Proceeds
- Expenditure of Debt Proceeds
- Record Retention
- Continuing Disclosure

VI. Debt Management Strategies

When selecting a debt management strategy, all options will be evaluated within the context of balancing the goals of ~~limiting~~ managing risk and achieving the lowest cost of capital possible. In order to ~~limit~~ manage risk of the University's debt portfolio risk, ~~the University will manage debt~~ will be assessed on a portfolio, rather than a transactional or project specific basis.

Described below are some of the key debt management strategies and tools that can be utilized to achieve the University's goals:

1. Methods of Sale

The University will consider various methods of sale. Negotiated, competitive, private placement, and bank qualified sales will be considered on an individual transaction basis. Issue size and complexity will be factors in determining which method of sale to pursue.

2. Fixed versus Variable Rate Allocation

Variable rate debt can provide a lower cost of capital, but introduces additional risks. The University will carefully examine the risks and rewards of variable rate exposure. Variable rate debt should only be used as an integral part of a long-term strategy and should not exceed twenty percent of the total debt portfolio ~~or fifty percent of total operating cash.~~

3. Purchase of Insurance or Credit Enhancement

The University will evaluate insurance and credit enhancement opportunities and utilize them if they are deemed cost effective.

4. Call Features

The University may use call provisions when issuing debt. Call features should be structured to provide maximum flexibility relative to cost.

5. Refunding Opportunities

The University will monitor its debt portfolio for refunding and/or restructuring opportunities. For a stand-alone refunding for savings, the University will generally enter into a transaction that produces at least a 3% present value savings (based upon the amount of callable bonds or certificates). The University may also seek to refinance debt for legal reasons, such as to ensure compliance with IRS regulations or to address any bond document related issues, including eliminating restrictive covenants, payment obligations, reserve and/or security requirements or other obligations, or from consolidation into larger, more cost-effective transactions. Advance refunding¹ transactions must weigh the current opportunity against possible future refunding opportunities.

6. Selection of Underwriters and Participants on the Selling Team

The members of the selling team, including the senior and co-managing underwriters, bond counsel, financial advisor and other service providers, will be selected in compliance with the Illinois Procurement Code. The selling team members assembled should complement the specific needs of the particular transaction. The University will reserve the right to utilize a competitive process for any single debt issue.

7. Public-Private Partnerships

Third parties may provide other types of funding for capital investments and other needs. When considering public-private partnerships, the University will assess the direct or indirect impact on the University's debt position or overall credit profile.

8. Taxable Debt

The University will manage its debt portfolio to minimize its taxable component in order to keep its cost of borrowing as low as possible. The University may utilize taxable debt for projects ineligible for tax-exempt financing or when compliance with tax-exempt financing rules is an administrative burden. Taxable debt would be issued pursuant to the same legal and regulatory authority as tax-exempt debt.

VII. Debt Policy Monitoring

The Board Treasurer is responsible for implementing this Debt Policy and will periodically review the policy to ensure it remains consistent with the University's objectives and industry standards. Any recommendations for changes to the policy will be brought to the Board of Trustees.

Footnotes

¹ The Tax Cuts and Jobs Act of 2017 eliminated the ability of governmental issuers and issuers of qualified 501(c)(3) bonds to issue advance refunded bonds on a tax-exempt basis after December 31, 2017. IRC Section 149(d) places limits on advance refundings which it defines as a bond issued to advance refund another bond more than 90 days before the redemption of the refunded bond.

Attribution

This policy was developed, in part, or incorporates language, based upon the debt policies of the University of Illinois, University of North Carolina and Oregon State University. Because legal structure and debt issuance are governed by state and federal laws and statutes, this policy may look very similar to other institutions.

Southern Illinois University
Board of Trustees
February 9, 2023

APPROVAL OF PURCHASE: 340B PHARMACEUTICAL PROGRAM,
SCHOOL OF MEDICINE, SIUC

Summary

This matter seeks approval to increase the award amount for the SIU School of Medicine 340B Pharmaceutical Program for the purchase of commodities from McKesson Medical Surgical Incorporated.

Rationale for Adoption

The School of Medicine's Center for Family Medicine currently participates in the federal 340B Pharmaceutical Program, which is regulated by the Office of Pharmaceutical Affairs (OPA) and managed by Health Resources and Services Administration (HRSA).

This program provides patients the ability to purchase outpatient medications and medical supplies at significantly reduced costs. The drug manufacturers are required to pass the savings on to the program participants. The total cost of this purchase will be funded by non-appropriated funds and revenue generated through the 340B Pharmaceutical Program.

Due to the success of the program, expenditures for the current fiscal year are projected to exceed the amount previously approved by the Board of Trustees in April 2022. This matter seeks to increase the previously approved award to McKesson Medical Surgical Incorporated by an additional \$1,500,000 for a total award of \$3,300,000.

The provisions of the Illinois Procurement Code do not apply to contracts for medical services necessary for the delivery of care and treatment at medical facilities utilized by SIU.

The Chancellor, SIUC, and the Dean and Provost of the SIU School of Medicine have recommended this matter to the President.

Resolution

BE IT RESOLVED, By the Board of Trustees of Southern Illinois University in a regular meeting assembled, That:

(1) The amendment to provide commodities for the SIU School of Medicine to participate in the 340B Pharmaceutical Program be amended and increased by \$1,500,000 for a total cost of \$3,300,000 to McKesson Medical Surgical, Incorporated for a period to extend through June 30, 2023;

(2) The Board of Trustees hereby authorizes the purchase of pharmaceutical products associated with the 340B Pharmaceutical Program, and;

(3) The expenditure will be funded by non-appropriated SIU School of Medicine funds and 340B Pharmaceutical Program revenue, and;

(4) The President of Southern Illinois University be and is hereby authorized to take whatever action may be required in the execution of this resolution in accordance with established policies and procedures.

Southern Illinois University
Board of Trustees
February 9, 2023

APPROVAL TO ACQUIRE REAL ESTATE:
1904 NORTH ILLINOIS AVENUE, CARBONDALE,
HEAD START PROGRAM, SIUC

Summary

This matter seeks approval to acquire real property located at 1904 North Illinois Avenue, Carbondale, Illinois, for the Head Start program.

Rationale for Adoption

Policies of the Board of Trustees require the Board of Trustees approval of the purchase of real property.

The Head Start program at SIU Carbondale has served the residents of southern Illinois for 50 years. It currently operates programs in Carbondale, Carterville, Marion and Murphysboro serving more than 350 children from the ages of 3-5.

The proposed purchase is a rental house, shed and property that is adjacent to the existing Carbondale Head Start property. The University plans to demolish the house and shed to create a large parcel of open land directly in front of the Head Start property to improve the aesthetics and safety of the program. The purchase, which is a total of 0.59 acres, was noted as part of the Head Start program's long-term plan when the Board authorized the purchase of an adjacent house and parcel of land in 2020.

Funding for this project will come from non-appropriated funds available to the Head Start program. The purchase price for the house and property is \$104,000, which is 12% less than the appraised value, plus associated closing costs.

This matter is recommended for adoption by the Chancellor.

Resolution

BE IT RESOLVED, By the Board of Trustees of Southern Illinois University in regular meeting assembled, That:

(1) The request to purchase the property at 1904 North Illinois Avenue, Carbondale, Illinois, be and is hereby approved at a total cost of approximately \$110,000.

(2) Funding for this purchase shall be from a non-appropriated source.

(3) The President of Southern Illinois University be and is hereby authorized to take whatever action may be required in the execution of this resolution in accordance with established policies and procedures.

Southern Illinois University
Board of Trustees
February 9, 2023

AWARD OF CONTRACTS: RESURFACE/REBUILD VARIOUS PARKING LOTS, AND
PARKING ROADWAYS AND INSTALL UPDATED LIGHTING, SIUE

Summary

This matter awards contracts in the amount of \$6,622,937 to improve various parking lots and roadways on the SIUE campus.

Rationale for Adoption

On April 28, 2022, the SIU Board of Trustees approved the project and budget to Resurface/Rebuild Various Parking Lots and Parking Roadways, Construct Parking Lot H and WH, and Install Updated Lighting, SIUE. The approved estimated budget of the total project was \$9,140,000 and will be funded from bond proceeds with debt service payments to be paid with parking fees.

The project specified that the construction of the new Woodland Hall would occur in the initial phase in order to facilitate the use of Lot WH for construction of the new Health Sciences Building. The construction contracts for the new Woodland Hall parking lot were awarded at the July 21, 2022, Board of Trustees meeting and construction has commenced.

The estimated design, construction and contingency costs for the work planned for Parking Lot A (North), Lot E, Lot 7, Lot 9, Roadways P1, P2, and P3, plus the lighting improvements for Lots 8 and B is \$7,671,330. The project includes new pavement markings, curbs, replacing/constructing accessible curb ramps, sidewalks, conversion to low level LED lighting in all the lots, adding EV charging stations in Lot B and Lot E, and adding/replacing emergency phones as needed.

Bids received on December 20, 2022, were favorable and awarding the contracts is requested. A summary of the bids received is attached for review. The Chancellor and the Interim Vice Chancellor for Administration, SIUE, have recommended this matter to the President.

Considerations Against Adoption

The work included in this project will cause a temporary inconvenience to those in the general vicinity of the various parking lots and parking roadways. Work will be scheduled during the summer of 2023 to minimize interruptions and inconveniences.

Resolution

BE IT RESOLVED, By the Board of Trustees of Southern Illinois University in regular meeting assembled, That:

(1) The contracts to perform construction work required to resurface/rebuild various parking lots and parking roadways, and install updated lighting on the SIUE campus, be and are hereby awarded to the following:

- a. General Contractor \$5,367,475
Byrne & Jones Construction, St. Louis, MO
- b. Electrical Contractor \$1,255,462
Pyramid Electrical Contractors, Fairview Heights, IL

(2) The project will be funded from bond proceeds with debt service payments to be paid with parking fees.

(3) The President of Southern Illinois University be and is hereby authorized to take whatever action may be required in the execution of this resolution in accordance with established policies and procedures.

Parking Lot Improvements RFQ 2371
December 20,2022 10:00 a.m./2:00 p.m.

			
Contractors	Base Bid G-1	Base Bid G-2	
Byrne & Jones Construction 13940 St. Charles Rock Road St. Louis, MO 63044	\$ 2,577,775.00	\$ 2,789,700.00	
The Kilian Corporation 608 South Independence Street Mascoutah, IL 62258	\$ 2,829,785.00	\$ 2,998,675.00	
Rooters American Maintenance Inc. 350 Carter Street PO Box 175 Beckemeyer, IL 62219	\$ 2,856,380.00	\$ 3,339,900.00	
Keller Construction Inc. 22 Illini Drive Glen Carbon, IL 62034	\$ 3,099,800.00	No Bid	
DMS Contracting Inc. 10243 Fuesser Road Mascoutah, IL 62258	\$ 3,167,000.00	\$ 3,425,000.00	
Stutz Excavating Inc. 3837 Fosterberg Road Alton, IL 62002	No Bid	\$ 3,800,000.00	

Parking Lot Improvements RFQ 2371
December 20,2022 10:00 a.m./2:00 p.m.

			
Electrical Contractors	Base Bid E-1	Base Bid E-2	Alt E-1
Pyramid Electrical Contractors 300 Monticello Place Fairview Heights IL 62208	\$ 348,707.00	\$ 394,927.00	\$ 511,828.00
Wissehr Electric Inc 5801 W State Route 161 Belleville IL 62223	\$ 479,200.00	\$ 591,900.00	\$ 639,100.00

Southern Illinois University
Board of Trustees
February 9, 2023

APPROVAL OF EASEMENTS: TEMPORARY CONSTRUCTION EASEMENTS, CITY
OF EDWARDSVILLE, AND PERMANENT EASEMENT, ILLINOIS DEPARTMENT OF
TRANSPORTATION, ILLINOIS HIGHWAY 157, SIUE

Summary

This matter proposes granting two temporary construction easements totaling 0.099 acres to the City of Edwardsville and a permanent easement of 0.0233 acres to the Illinois Department of Transportation for the City of Edwardsville to construct a bicycle and pedestrian trail adjacent to the Edwardsville campus and Illinois Highway 157.

Rationale for Adoption

The City of Edwardsville has initiated a multi-phased expansion of the trail network along Illinois Highway 157 to enhance transportation in the city and provide a pedestrian and cycling route for Edwardsville area residents to access the multiple Edwardsville business districts and the SIUE campus.

The attached plat maps were prepared by the City of Edwardsville and have been reviewed by University officials. The easement maps of the proposed temporary easements and the permanent easement are attached as Exhibit A and Exhibit B. The project will expand the bike trail system along Highway 157 within an existing Illinois Department of Transportation (IDOT) right-of-way. A temporary construction easement will allow for the extension of a cross road culvert across from the new Trace on the Parkway development near University Park Drive under the proposed ten-foot shared bike path. In addition, a permanent easement will be granted to the IDOT so the culvert can be maintained by IDOT and/or City personnel. A second temporary construction easement north of East University Drive will be granted to the City of Edwardsville to build the embankment needed for the trail. This finished area will be a grassy slope suitable for mowing. The trail extension work is planned for summer 2023.

The City of Edwardsville has received Transportation Alternative Program (TAP) funds from the East-West Gateway Council of Governments. The program is funded through the Federal Highway Administration for a variety of transportation projects such as pedestrian and bicycle facilities, safe routes to school projects, community improvements and environmental mitigation related to stormwater and habitat connectivity. The City of Edwardsville will be responsible for the expense of designing and constructing this trail extension and will also be responsible for its long-term care and maintenance.

The Chancellor and Interim Vice Chancellor for Administration recommend this matter for approval.

Considerations Against Adoption

This project may cause a temporary disruption in the easement construction areas, however, it should not have an impact on campus traffic or activities.

Resolution

BE IT RESOLVED, By the Board of Trustees of Southern Illinois University in a regular meeting assembled, That: temporary construction easements and a permanent easement, as presented and described in Exhibit A and Exhibit B attached hereto, be and hereby are granted to the City of Edwardsville and the Illinois Department of Transportation.

BE IT FURTHER RESOLVED, That: the President of Southern Illinois University be and is hereby authorized to take whatever action may be required in the execution of this resolution in accordance with established policies and procedures.

N/F SIUE BOARD OF TRUSTEES
 14-1-15-15-00-000-001
 14-1-15-15-00-000-001.001
 14-1-15-15-00-000-001.002
 14-1-15-15-00-000-001.003

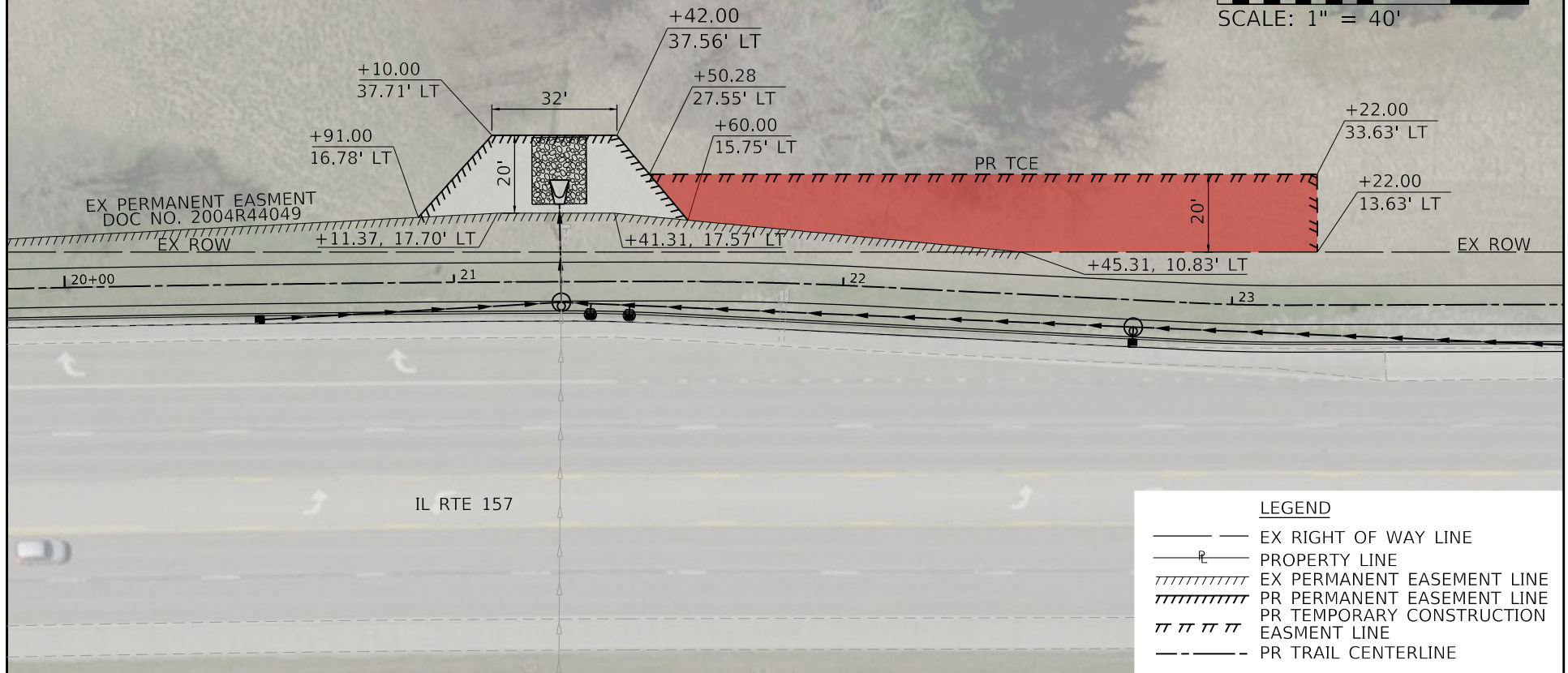
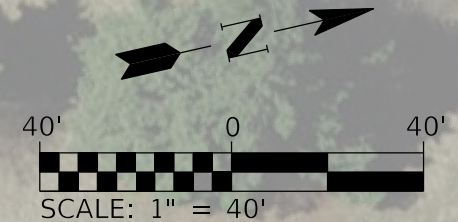

LEGEND

- EX RIGHT OF WAY LINE
- PROPERTY LINE
- //////// EX PERMANENT EASEMENT LINE
- //////// PR PERMANENT EASEMENT LINE
- ||||| PR TEMPORARY CONSTRUCTION EASEMENT LINE
- - - - PR TRAIL CENTERLINE

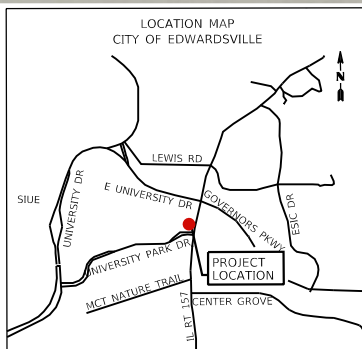

PROPOSED USE:

AREA OF TRACT

PERMANENT EASEMENT

1,015 SF ±

0.0233 ACRE ±

TEMPORARY EASEMENT

2,941 SF ±

0.0675 ACRE ±



100 Lanter Court, Suite 1
 Collinsville, IL 62234
 618.345.2200
 www.oatesassociates.com

Collinsville St. Louis Belleville St. Charles
 ILLINOIS DESIGN FIRM LICENSE NO. 184,001115

**IL ROUTE 157 TRAIL
 SECTION 21-00111-03-BT
 CITY OF EDWARDSVILLE
 MADISON COUNTY, ILLINOIS**

PROJECT NO.:
 221086

DATE:
 12/09/2022

REVISION:

EXHIBIT

A

N/F SIUE BOARD OF TRUSTEES
 14-1-15-15-00-000-001
 14-1-15-15-00-000-001.001
 14-1-15-15-00-000-001.002
 14-1-15-15-00-000-001.003

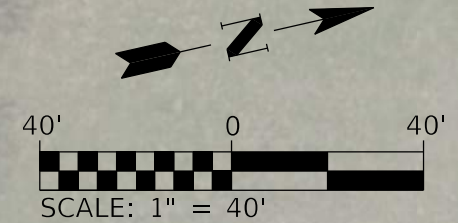

EX PERMANENT EASEMENT
 DOC NO. 2004R44049

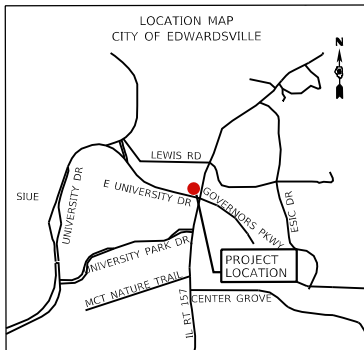
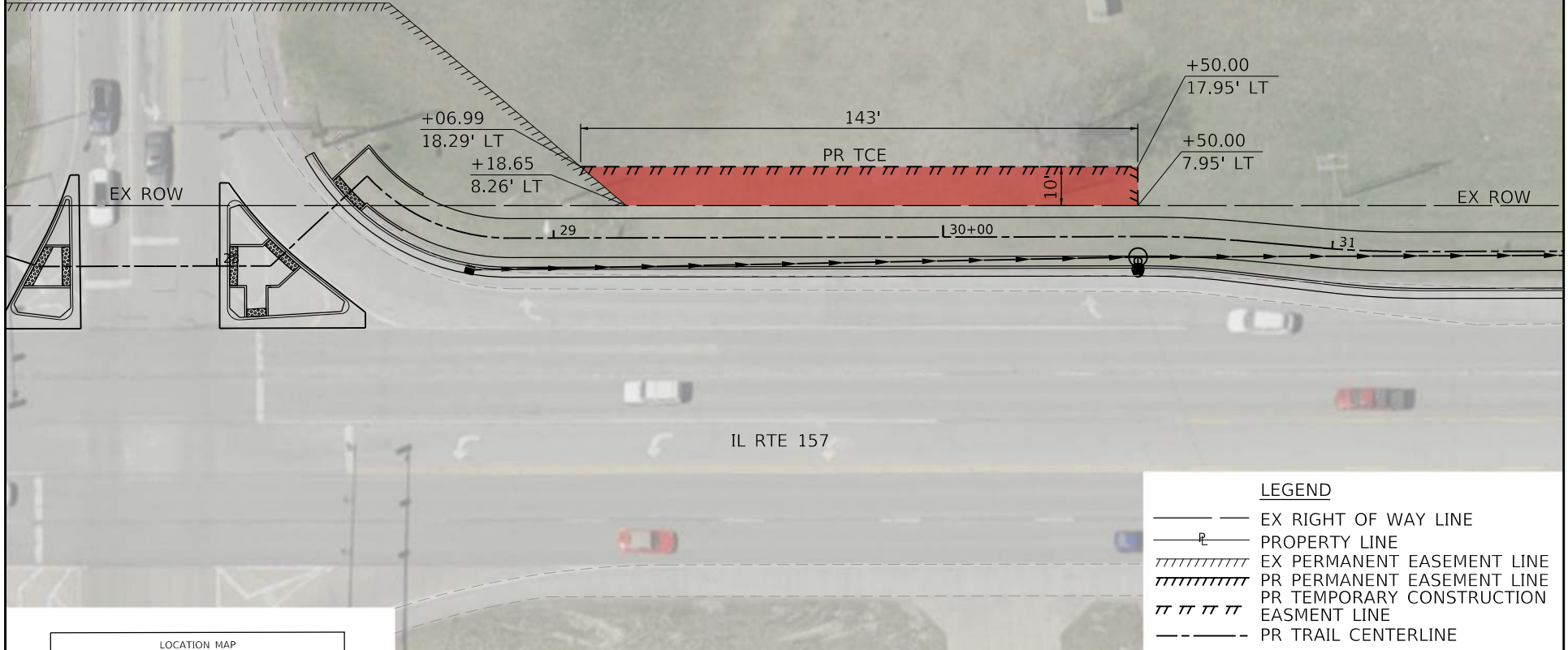

PROPOSED USE:		AREA OF TRACT	
TEMPORARY EASEMENT		1,372 SF ±	0.0315 ACRE ±
 <p>100 Lanter Court, Suite 1 Collinsville, IL 62234 618.345.2200 www.oatesassociates.com</p> <p>Collinsville St. Louis Belleville St. Charles ILLINOIS DESIGN FIRM LICENSE NO.: 184,001115</p>	<p>IL ROUTE 157 TRAIL SECTION 21-00111-03-BT CITY OF EDWARDSVILLE MADISON COUNTY, ILLINOIS</p>		PROJECT NO.: 221086
			DATE: 12/09/2022
			REVISION:
		EXHIBIT B	

Southern Illinois University
Board of Trustees
February 9, 2023

REVISED PROJECT BUDGET AND AWARD OF CONTRACTS:
BIOLAUNCH CORE FACILITY, MCLAFFERTY ANNEX
CARBONDALE CAMPUS, SIUC

Summary

This matter seeks to revise the project budget and award the contracts for the buildout of the BioLaunch Core Facility at McLafferty Annex. Bids were received and the award of contracts is now requested.

Rationale for Adoption

At the April 28, 2022, Board of Trustees meeting, the project to buildout a 7,500 square foot area at McLafferty Annex for the BioLaunch Core Facility was approved.

The BioLaunch Core Facility will provide a state-of-the-art research suite for faculty use, start-up companies, and private firms in the region. The suite will include a Biotechnology Core Laboratory, an Analytical Core Laboratory, and a Business Support Annex and will be staffed by current SIU scientists and researchers.

This project is primarily funded by a grant through the Illinois Department of Commerce and Economic Opportunity (DCEO) Wet Lab Capital Construction Program. Initially, the Board approved the project and budget with the state's grant funding of \$2,734,008 and a supplemental amount of \$500,000 from non-appropriated university funds to fulfill the grant objectives. However, after two rounds of bids to ensure the most competitive prices possible, additional funding is needed. Specifically, the review of the bids received on November 3, 2022, resulted in an additional need of \$1,300,000. The source of these non-appropriated university funds has been identified. The total cost of the project is now estimated to be \$4,534,008.

As such, the estimated construction cost is now \$3,800,000. The DCEO grant requires a university match that will be satisfied with the McLafferty Annex building value and equipment from the SIU Mass Spectrometry Facility and the SIU Fermentation Science Institute. It is estimated that an additional \$700,000 of new equipment and furnishings will be purchased through normal procurement procedures that do not require Board approval to complete the goals of the grant. Bids for this project are shown on the attached bid tabs.

The Chancellor, the Vice Chancellor for Research, and the Vice Chancellor for Administration and Finance, SIUC, have recommended this matter to the President.

Resolution

BE IT RESOLVED, By the Board of Trustees of Southern Illinois University in regular meeting assembled, That:

(1) The revised project budget for the construction of the BioLaunch Core Facility, Carbondale Campus, SIUC at an estimated cost of \$3,800,000 be and is hereby approved.

(2) The contract for the GENERAL work for the construction of the BioLaunch Core Facility, Carbondale Campus, SIUC, be and is hereby awarded to JL Robinson Development & Construction Company, Carbondale, IL, including the base bid, alternate 1A, alternate 1B, alternate 2A, alternate 3A, alternate 4A, and alternate 5 in the amount of \$1,162,400.

(3) The contract for the PLUMBING work for the construction of the BioLaunch Core Facility, Carbondale Campus, SIUC, be and is hereby awarded to A&W Plumbing & Heating, Inc., Murphysboro, IL, including the base bid, alternate 1A, alternate 1B, alternate 2A, alternate 3A, and alternate 4A in the amount of \$502,700.

(4) The contract for the MECHANICAL work for the construction of the BioLaunch Core Facility, Carbondale Campus, SIUC, be and is hereby awarded to Heartland Mechanical Contractors, Murphysboro, IL, including the base bid, alternate 1A, alternate 1B, alternate 2A, alternate 3A, and alternate 4A in the amount of \$478,000.

(5) The contract for the ELECTRICAL work for the construction of the BioLaunch Core Facility, Carbondale Campus, SIUC, be and is hereby awarded to WJ Burke Electric Company, Murphysboro, IL, including the base bid, alternate 1A, alternate 1B, alternate 2A, alternate 3A, and alternate 4A in the amount of \$550,600.

(6) Funding for this project will come from a grant awarded to the university from the Illinois Department of Commerce and Economic Opportunity (DCEO) and non-appropriated university funds.

(7) The President of Southern Illinois University be and is hereby authorized to take whatever action may be required in the execution of this resolution in accordance with established policies and procedures.

BID TABULATION												
IFB M100422	GIR 22053	BioLaunch Core Facility										
General		Bid Opening: 11/3/2022										
 Invitations: 7 No Bid: 0 No Reply: 4	B A S E B I D	A L T E R N A T E B I D 1A	A L T E R N A T E B I D 1B	A L T E R N A T E B I D 2A	A L T E R N A T E B I D 2B	A L T E R N A T E B I D 3A	A L T E R N A T E B I D 3B	A L T E R N A T E B I D 4A	A L T E R N A T E B I D 4B	A L T E R N A T E B I D 5	A L T E R N A T E B I D 6	T O T A L A C C E P T E D
BIDDERS												
JL Robinson Development & Construction Company 501 W. Industrial Park Road Carbondale, IL 62901	\$524,000	\$160,000	\$4,400	\$315,000	(\$22,000)	\$101,000	(\$600)	\$36,000	(\$2,200)	\$22,000	(\$5,200)	\$1,162,400
HE Mitchell Construction 600 E. Walnut Street Harrisburg, IL 62946	\$597,000	\$128,000	\$7,500	\$299,000	\$0	\$100,000	\$3,500	\$30,000	\$2,000	\$27,000	(\$7,000)	\$1,188,500
Samron Midwest Contracting 1510 N. 7th Street Murphysboro, IL 62966	\$722,722	\$152,812	\$8,732	\$320,401	(\$13,624)	\$95,862	\$3,844	\$25,274	\$1,685	\$39,237	(\$478)	\$1,365,040

Alternate Bid 1A -- Provide Business Support Annex & Corridor 0102 construction

Alternate Bid 1B -- Provide new cabinets in Business Support Annex Kitchen Prep

Alternate Bid 2A -- Provide Analytic Core Lab A 0112 construction

DEDUCT Alternate Bid 2B -- Provide salvaged laboratory casework in the Analytical Core Lab A area in lieu of new casework

Alternate Bid 3A -- Provide the Analytical Core Lab B 0114 construction

DEDUCT Alternate Bid 3B -- Provide salvaged laboratory casework in the Analytical Core Lab B 0114 area in lieu of new

Alternate Bid 4A -- Provide Distillation Analysis Lab 109g construction

DEDUCT Alternate Bid 4B -- Provide salvaged laboratory casework in the Distillation Analysis Lab 109g in lieu of new

Alternate Bid 5 -- Provide new exterior windows and reinstall salvaged hollow metal windows with new glazing in interior

DEDUCT Alternate Bid 6 -- Provide salvaged laboratory casework in Biotech Core Lab area (base bid) in lieu of new casework

BID TABULATION						
IFB M100422 Plumbing	GIR 22053	BioLaunch Core Facility Bid Opening: 11/3/2022				
 Invitations: 3 No Bid: 0 No Reply: 0 BIDDERS	B A S E B I D	A L T E R N A T I V E B I D 1A	A L T E R N A T I V E B I D 2A	A L T E R N A T I V E B I D 3A	A L T E R N A T I V E B I D 4A	T O T A L A C C E P T E D
A & W Plumbing & Heating, Inc. 11 Alliance Avenue Murphysboro, IL 62966	\$433,700	\$12,000	\$32,300	\$20,800	\$3,900	\$502,700
Litton Enterprises, Inc. 3305 W. Commercial Road Maion, IL 62959	\$446,485	\$19,338	\$58,439	\$41,271	\$5,926	
Southern Illinois Piping Contractors, Inc 1100 S. Reed Station Road Carbondale, IL 62902	\$438,200	\$12,200	\$50,400	\$30,400	\$5,500	

Alternate Bid 1A -- Provide Business Support Annex & Corridor 0102 construction

Alternate Bid 2A -- Provide Analytic Core Lab A 0112 construction

Alternate Bid 3A -- Provide the Analytical Core Lab B 0114 construction

Alternate Bid 4A -- Provide Distillation Analysis Lab 109g construction

BID TABULATION						
IFB M100422 Mechanical	GIR 22053	BioLaunch Core Facility Bid Opening: 11/3/2022				
 Invitations: 3 No Bid: 0 No Reply: 0	B A S E B I D	A L T E R N A T I V E B I D 1A	A L T E R N A T I V E B I D 2A	A L T E R N A T I V E B I D 3A	A L T E R N A T I V E B I D 4A	T O T A L A C C E P T E D
BIDDERS						
Heartland Mechanical Contractors 511 Health Department Road Murphysboro, IL 62966	\$296,500	\$25,400	\$96,400	\$57,000	\$2,700	\$478,000
Southern Illinois Piping Contractors, Inc. 1100 S. Reed Station Road Carbondale, IL 62902	\$355,000	\$15,000	\$126,000	\$55,500	\$3,500	
A & W Plumbing & Heating, Inc. 11 Alliance Avenue Murphysboro, IL 62966	\$347,500	\$25,000	\$141,000	\$73,000	\$4,000	

Alternate Bid 1A -- Provide Business Support Annex & Corridor 0102 construction

Alternate Bid 2A -- Provide Analytic Core Lab A 0112 construction

Alternate Bid 3A -- Provide the Analytical Core Lab B 0114 construction

Alternate Bid 4A -- Provide Distillation Analysis Lab 109g construction

BID TABULATION						
IFB M100422 Electrical	GIR 22053	BioLaunch Core Facility Bid Opening: 11/3/2022				
 Invitations: 5 No Bid: 0 No Reply: 4 BIDDERS	B A S E B I D	A L T E R N A T I V E B I D 1A	A L T E R N A T I V E B I D 2A	A L T E R N A T I V E B I D 3A	A L T E R N A T I V E B I D 4A	T O T A L A C C E P T E D
WJ Burke Electric Company PO Box 462 Pmurfysboro, IL 62966	\$275,500	\$65,500	\$122,250	\$79,750	\$7,600	\$550,600

Alternate Bid 1A -- Provide Business Support Annex & Corridor 0102 construction

Alternate Bid 2A -- Provide Analytic Core Lab A 0112 construction

Alternate Bid 3A -- Provide the Analytical Core Lab B 0114 construction

Alternate Bid 4A -- Provide Distillation Analysis Lab 109g construction